



SHETLAND ISLANDS COUNCIL

CORPORATE SERVICES

FOR SALE – OFFERS INVITED

Brae Public Toilets, Brae, ZE2 9QQ

Closing Date: Thursday 27 February 2025 at 2.00pm



LOCATION:

The property is located in the village of Brae at Skelladale.

ACCOMMODATION:

The property has a flat roof which has been recovered with a plastic sheeting material. The property consists of male and female WC's and a cleaner's store. The gross floor area is 25m²

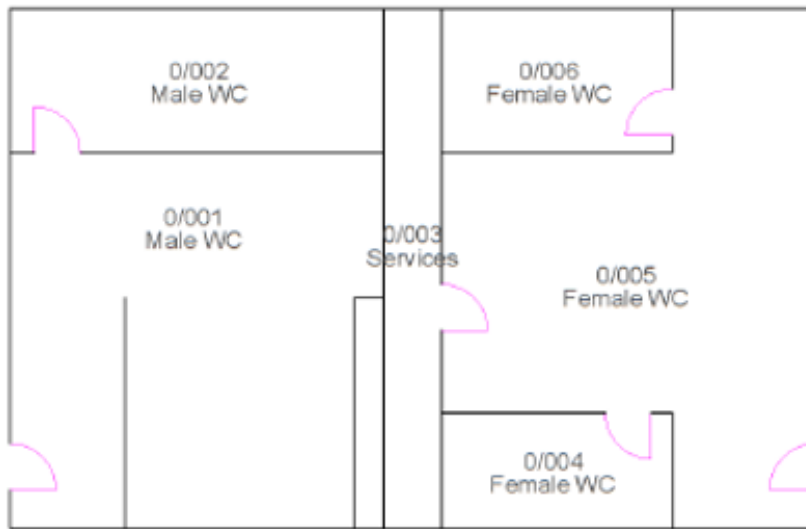

Not to scale

SERVICES:

Water, drainage and electricity are on site.

VIEWING:

For more information or to arrange a viewing please contact either Mike Taylor on 01595 744591 mike.taylor@shetland.gov.uk or Irvine Burgess on 01595 744571 irvine.burgess@shetland.gov.uk

ENTRY:

Early entry is available by arrangement.

PRICE:

Offers are invited for the sale of the building.

EPC Rating:

Exempt

RATEABLE VALUE:

£1,350

PLANNING:

Planning consent and/or Building Standards approval may be required for any proposed alterations or change of use. The prospective buyer should consult with the Shetland Islands Council Planning Service to fully understand any requirements that may be necessary.

SUBMITTING AN OFFER:

Please note that the closing date for expressions of interest is **2.00pm on Thursday 27 February 2025**. This should be e-mailed to Mike Taylor at the address above by the stated date and time. E-mails should be clearly titled with the relevant property name e.g. **'Offer for Brae Public Toilets, Brae'**.

Whilst the foregoing particulars are believed to be correct, their accuracy is not warranted.

The Council reserves the right to amend the closing date.

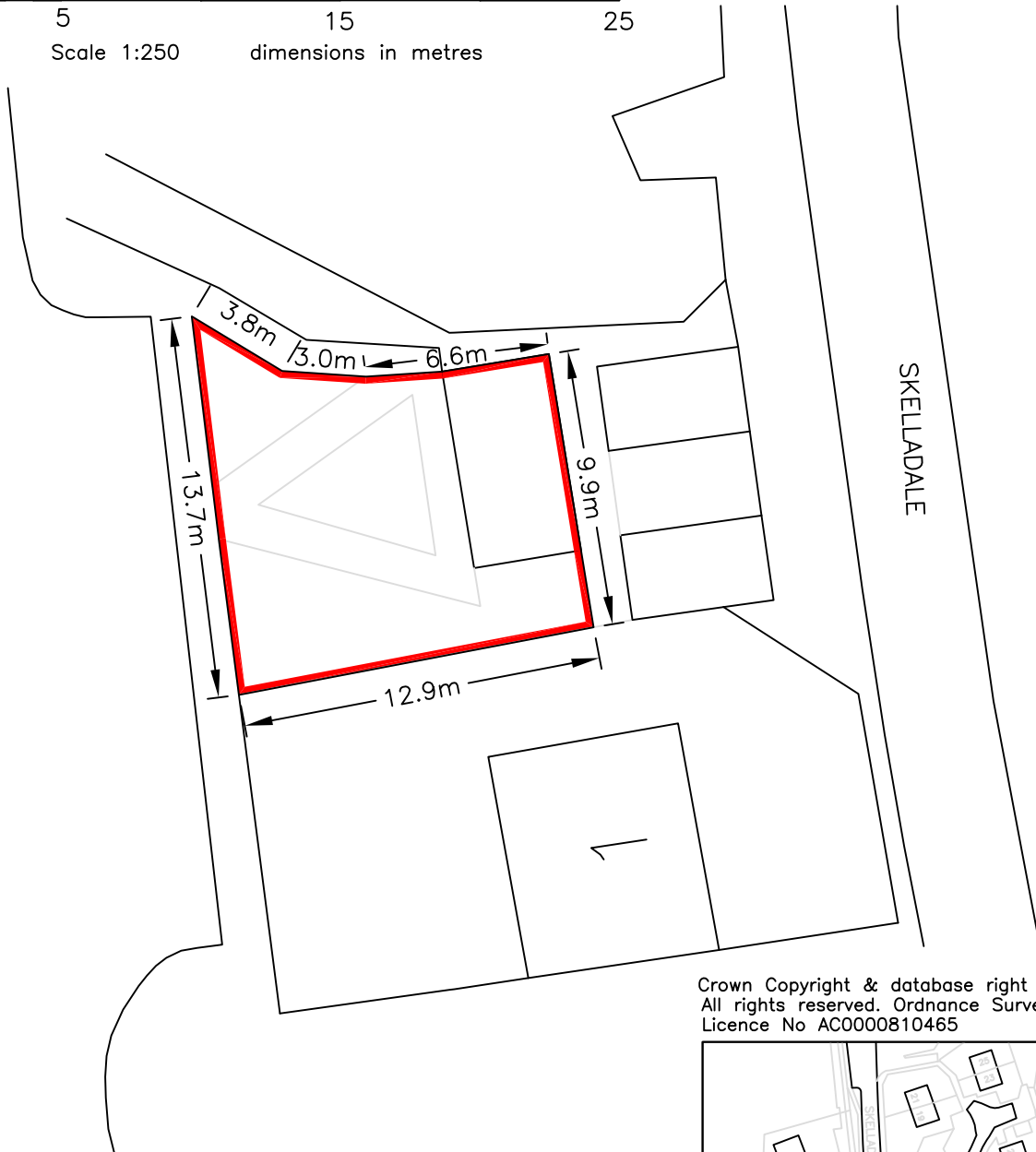
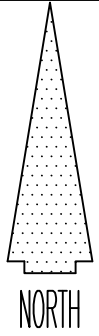
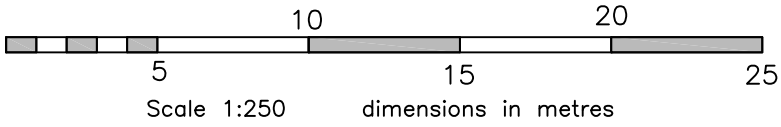

Crown Copyright & database right 2025
 All rights reserved. Ordnance Survey
 Licence No AC0000810465



SITE PLAN Scale 1:250

NOTE: Area outlined in red amounts to 137.3m² or there by

Brae Toilet

**Disposition
Plan**

Shetland Islands Council

CORPORATE SERVICES
 North Ness, Lerwick ZE1 0LZ
 Telephone: 01595 744550
 www.shetland.gov.uk



Date	Drawn	OS Grid Ref	Scale
Jan 2025	Irvine Burgess	HU 3667	1:250/1:2500

Org.No.	File No.	A4.